

WINDY CITY LABS 1. Signup & Setup Flow

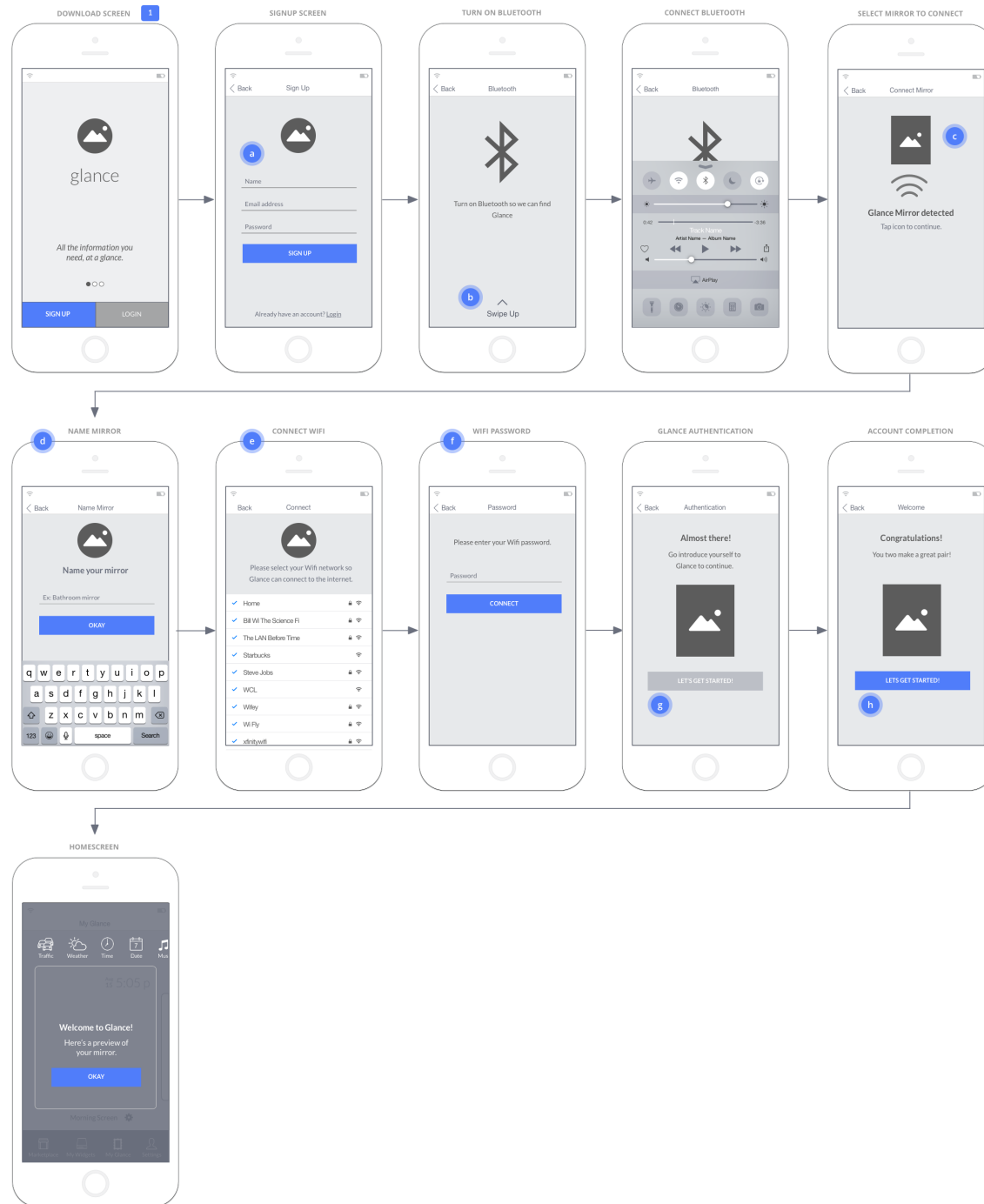

1 SIGNUP & SETUP FLOW FROM DOWNLOAD SCREEN

- 1.a** User signs up for secure account.
- 1.b** User swipes up to open default iPhone Control Center and activate bluetooth. Bluetooth connectivity required to detect nearby mirror.
- 1.c** User taps on mirror icon to select it (in case multiple Glance devices are detected).
- 1.d** User names mirror.
- 1.e** User selects from nearby Wifi networks.
- 1.f** User enters password for selected Wifi network.
- 1.g** 'LET'S GET STARTED' button is not activated until user completes mirror onboarding steps.
- 1.h** Once user has authenticated with Glance mirror, 'LET'S GET STARTED' button will be activated and they will be directed to Onboarding Flow.