

WINDY CITY LABS 4. Adding Widgets to Mirror (from My Widgets Page) Flow

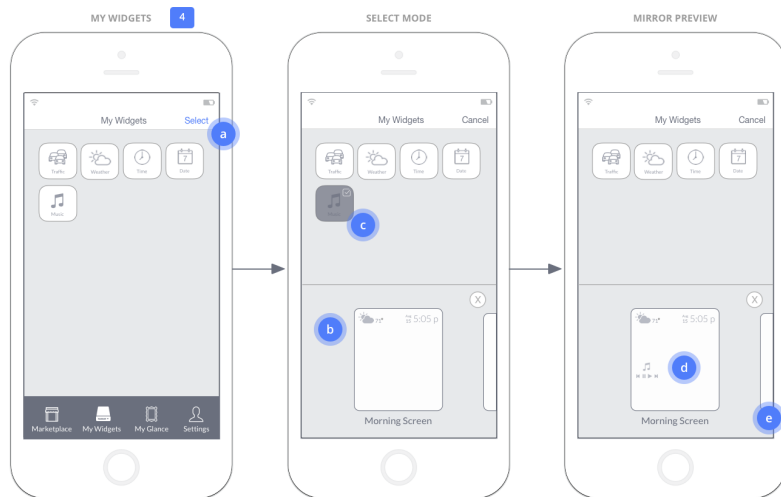

- 4 MY WIDGETS**
List of all widgets includes both default and downloaded widgets through the Marketplace.
- 4.a** User taps 'Select' to change to select mode.
- 4.b** Bottom navigation will disappear and a preview of their Glance screens will slide up from below.
- 4.c** User will drag widget onto preview screen to add it. Widget darkens upon selection. User is limited to selecting and dragging only one widget at a time. User can select up to a maximum of 10 widgets to place onto mirror.
- 4.d** When user lifts their finger, the preview screen will update with the chosen widgets. User can tap onto preview screen and will be taken to the full My Glance page where they can fully position and edit their screen.
- 4.e** User can swipe left and right between preview screens.